

XHV / XHVD

X-Proof Housing for Viewing Displays in Hazardous Areas

Features:

- Available for 1/8 DIN and DIN 144 x 72 mm Cases
- Meets NEMA 7 & 4 Specs.
- UL, cUL, CSA Certified
- Magnetic Reset Switch Available

Specifications:

This housing is designed and manufactured in compliance with UL Standard No. 1203 and CSA Standard C22.2 No. 25 & 30 for use in Class 1, Division 1, Groups B, C & D and Class II, Division I, Groups E, F & G hazardous locations.

Housing:

The housing is made from cast aluminum and sealed to meet NEMA 7 and 4 specifications.

To install a KEP unit, the cover must be removed and the KEP unit mounted in the sub panel provided.

Empty weight:

XHV = 19 lbs.
XHVD = 22 lbs.



XHVVD with ST2 Flow Computer

Dimensions:

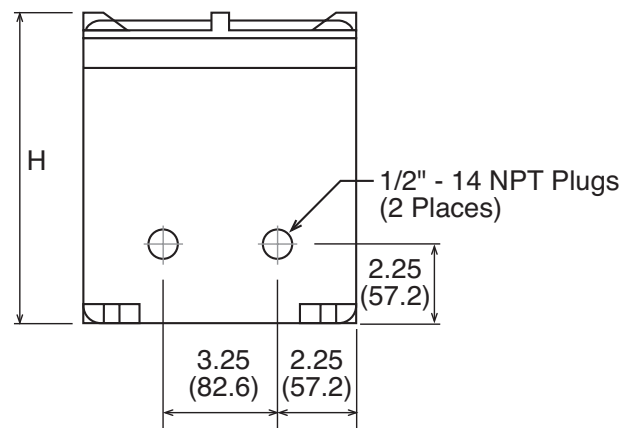
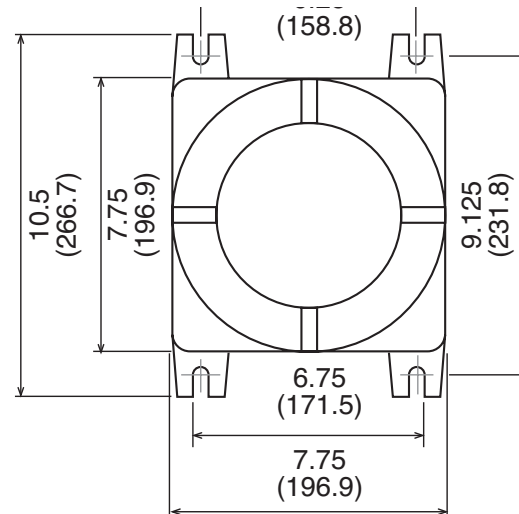

H
XHV = 8.5 (215.9)
XHVD = 11.5 (292.1)

Certifications



Class I, Groups B,C,D	}	}	UL 1203
Class II, Groups E,F,G			CSA C22.2 No. 25 & 30
TYPE 4			UL 50

Ordering Information

Example: XHV 7/4 A A S1

Series: _____
 XHV 7/4 (8.5" high for INT69, MRT, Reporter, etc.)
 XHVD 7/4 (11.5" high for SUPERtrol 1 and 2, LEVELtrol II)

Mounting Sub Panel: _____
 A = Panel for (1) 1/8 DIN unit (INT69, MRT, etc.)
 B = Panel for (2) 1/8 DIN units (INT69, MRT, etc.)
 C = Panel for (1) DIN 144 x 72mm unit (ST1, ST2, LT2, Reporter)

Assembly By KEP: _____
 A = Assembled by KEP
 X = No Assembly

Options: _____
 S1 = 1 Magnetic Reset Switch and Magnet
 S2 = 2 Magnetic Reset Switches and Magnet
S1 & S2 options are not available on SUPERtrol II (ST2) and all ST2 specials: MS748, ES749, ES761, ES762

Accessories:

XHVA-1 = Magnetic Switch
 XHVA-2 = Actuating Magnet

Note: When placing the order, the unit part number directly following the XHV part number on the Purchase Order is the one that will be assembled into the XHV housing.